

# Livermore Airway Business Park

TERRENCE J. ROSE, INC.  
REAL ESTATE

INVESTMENT & DEVELOPMENT

L I V E R M O R E , C A L I F O R N I A



208-274 Lindbergh Ave.

## Project 3

59,840+/- sq. ft.

**Light  
Industrial  
Warehouse  
Space for  
Lease**

- Convenient I-580/Airway Blvd. Freeway Accessibility
- Local Property Management
- Unit Sizes from 6,600+/- s.f.
- 2.5/1,000 Parking
- Tenant Controlled HVAC
- Sprinklered & Insulated
- 12' x 14' Grade Level & 12' x 16' Dock High Roll-Up Doors
- 18'-20' Interior Clearance
- 110/208V, 3-Phase Power
- Nearby Tenant Services, Restaurants, Wineries, Golf Courses, Tower-Controlled Airport

For Information Contact:

**Jennifer Walker / Debbie Athan**

Phone 925 455 1234 • Fax 925 455 1546 • [www.tjrinc.com](http://www.tjrinc.com)  
2600 Kitty Hawk Road, Suite 100, Livermore, California 94551

# Project 3 – 208-274 Lindbergh Ave.

L I V E R M O R E , C A L I F O R N I A

## Floor Plan

59,840+/- Sq. Ft.

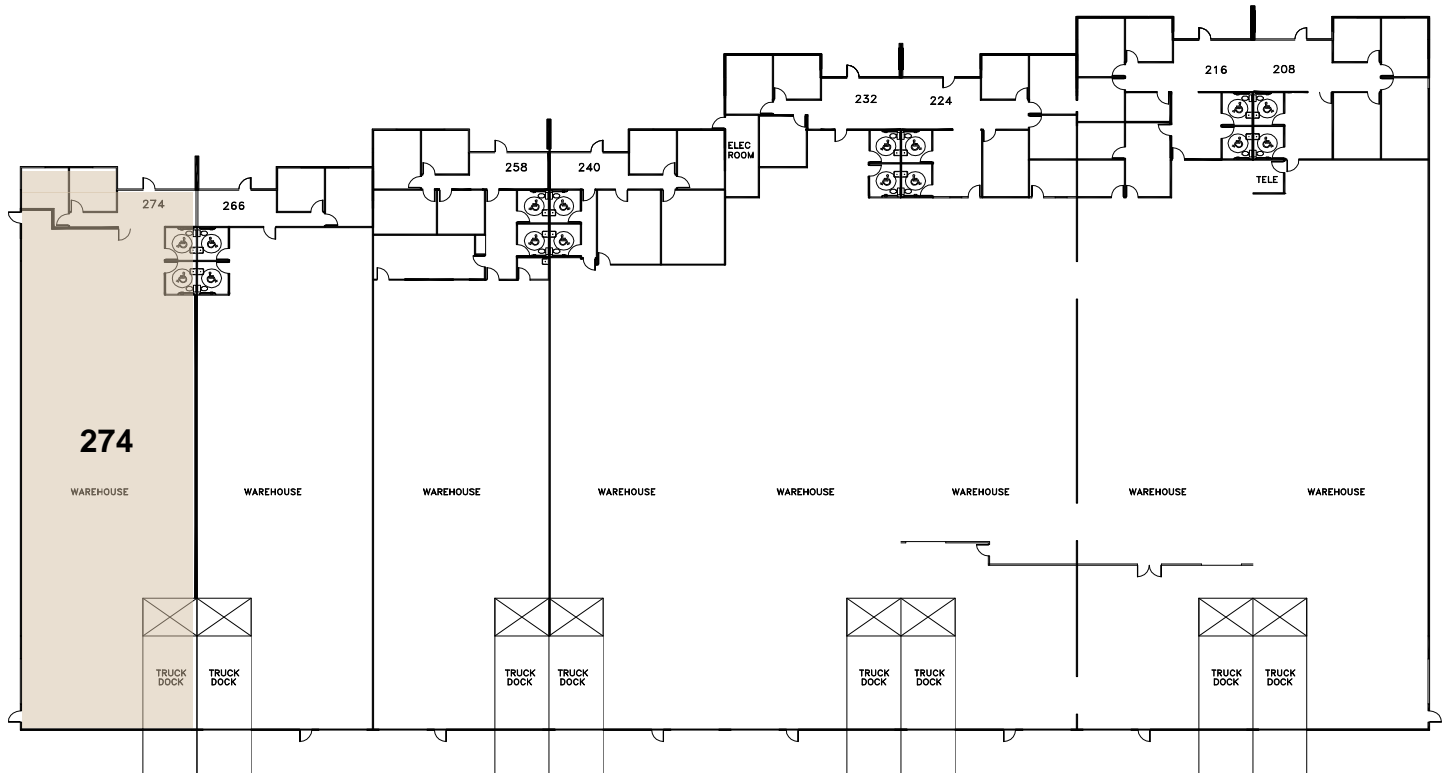

(Floor plan accuracy not warranted and may be changed or updated without notice.)

## Available Space

- 274 Lindbergh Ave. – 6,600+/- s.f.

## Map



MAP NOT TO SCALE



For Information Contact:

**Jennifer Walker / Debbie Athan**

Phone 925 455 1234 • Fax 925 455 1546 • www.tjrinc.com  
2600 Kitty Hawk Road, Suite 100, Livermore, California 94551