

Livermore Airway Business Park

TERRENCE J. ROSE, INC.
REAL ESTATE

INVESTMENT & DEVELOPMENT

L I V E R M O R E , C A L I F O R N I A



288-336 Lindbergh Ave.

Project 5

50,883+/- sq. ft.

**Light
Industrial
Warehouse
Space for
Lease**

- Convenient I-580/Airway Blvd. Freeway Accessibility
- Local Property Management
- Unit Sizes from 6,223+/- s.f.
- 3/1,000 Parking
- Tenant Controlled HVAC
- Sprinklered & Insulated
- 12' x 14' Grade Level & 12' x 16' Dock High Roll-Up Doors
- 18'-20' Interior Clearance
- 110/208V, 3-Phase Power
- Nearby Tenant Services, Restaurants, Wineries, Golf Courses, Tower-Controlled Airport

For Information Contact:

Jennifer Walker / Debbie Athan

Phone 925 455 1234 • Fax 925 455 1546 • www.tjrinc.com
2600 Kitty Hawk Road, Suite 100, Livermore, California 94551

Project 5 – 288-336 Earhart Way

L I V E R M O R E , C A L I F O R N I A

Floor Plan

50,883+/- Sq. Ft.

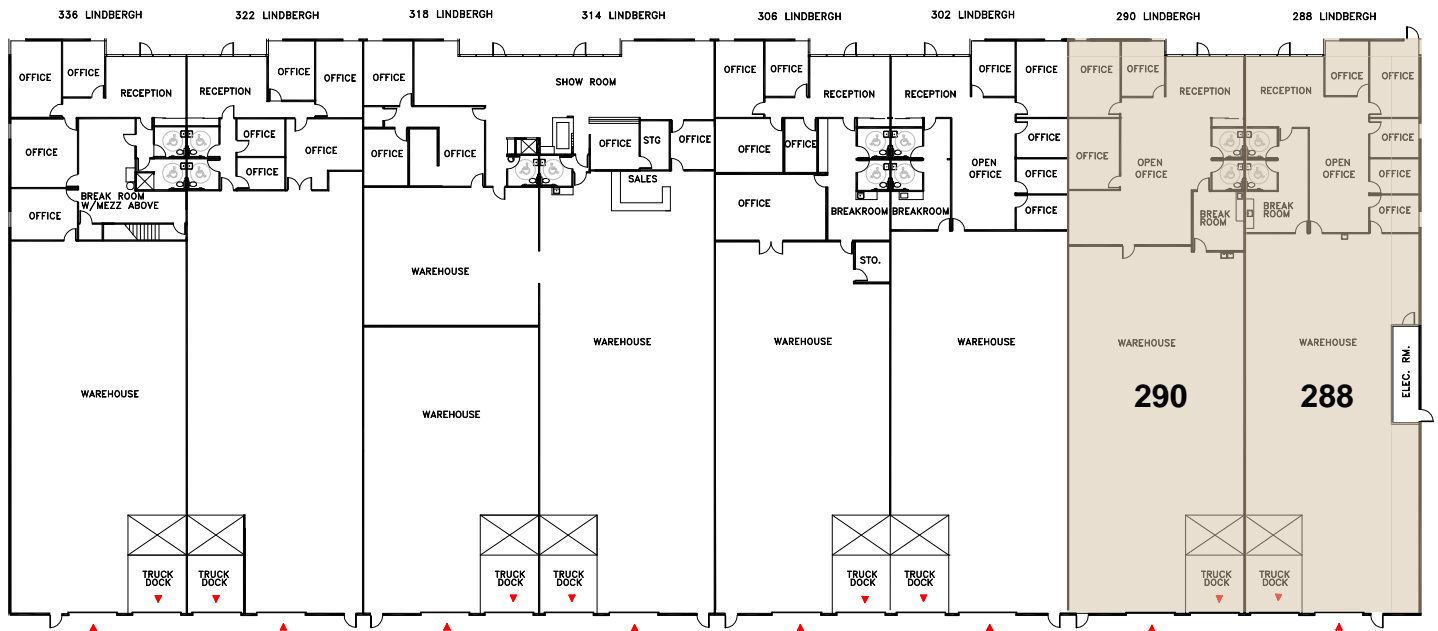

(Floor plan accuracy not warranted and may be changed or updated without notice.)

Map

Available Space

- 288 Lindbergh Ave. – 6,223+/- s.f.
- 290 Lindbergh Ave. – 6,380+/- s.f.

288 & 290 contiguous – 12,603+/- s.f.



MAP NOT TO SCALE



For Information Contact:

Jennifer Walker / Debbie Athan

Phone 925 455 1234 • Fax 925 455 1546 • www.tjrinc.com
2600 Kitty Hawk Road, Suite 100, Livermore, California 94551