

STRATEGIC GROWTH
STARTS HERE!



FOR LEASE

48,193± RSF Office/Flex
building divisible to
10,426± SF
3.48 acre site

Property Highlights:

- Located in the heart of the Hacienda Business Park
- Building and monument signage available
- Access to three roll-up doors
- Respected local ownership and property management
- Timely payment of commission
- 4.48/1,000 parking ratio
- Power 480 volts, 2000 Amps.

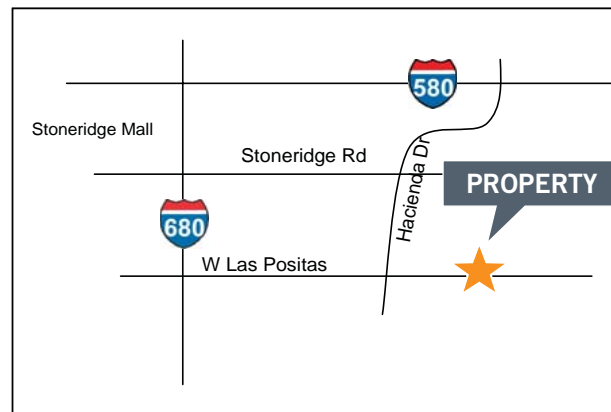

For more information, contact:

Justin Grilli
Vice President
925-621-3858
jgrilli@ctbt.com
LIC #01410373

Michael Copeland
Managing Partner
925-621-3855
mcpeland@ctbt.com
LIC #00898210

5000 Hopyard Road, Suite 205
Pleasanton, California 94588
ph: 925-621-3840
fx: 925-621-3841
www.ctbt.com

TERRENCE J. ROSE, INC.
REAL ESTATE

INVESTMENT & DEVELOPMENT

Divisibility Options

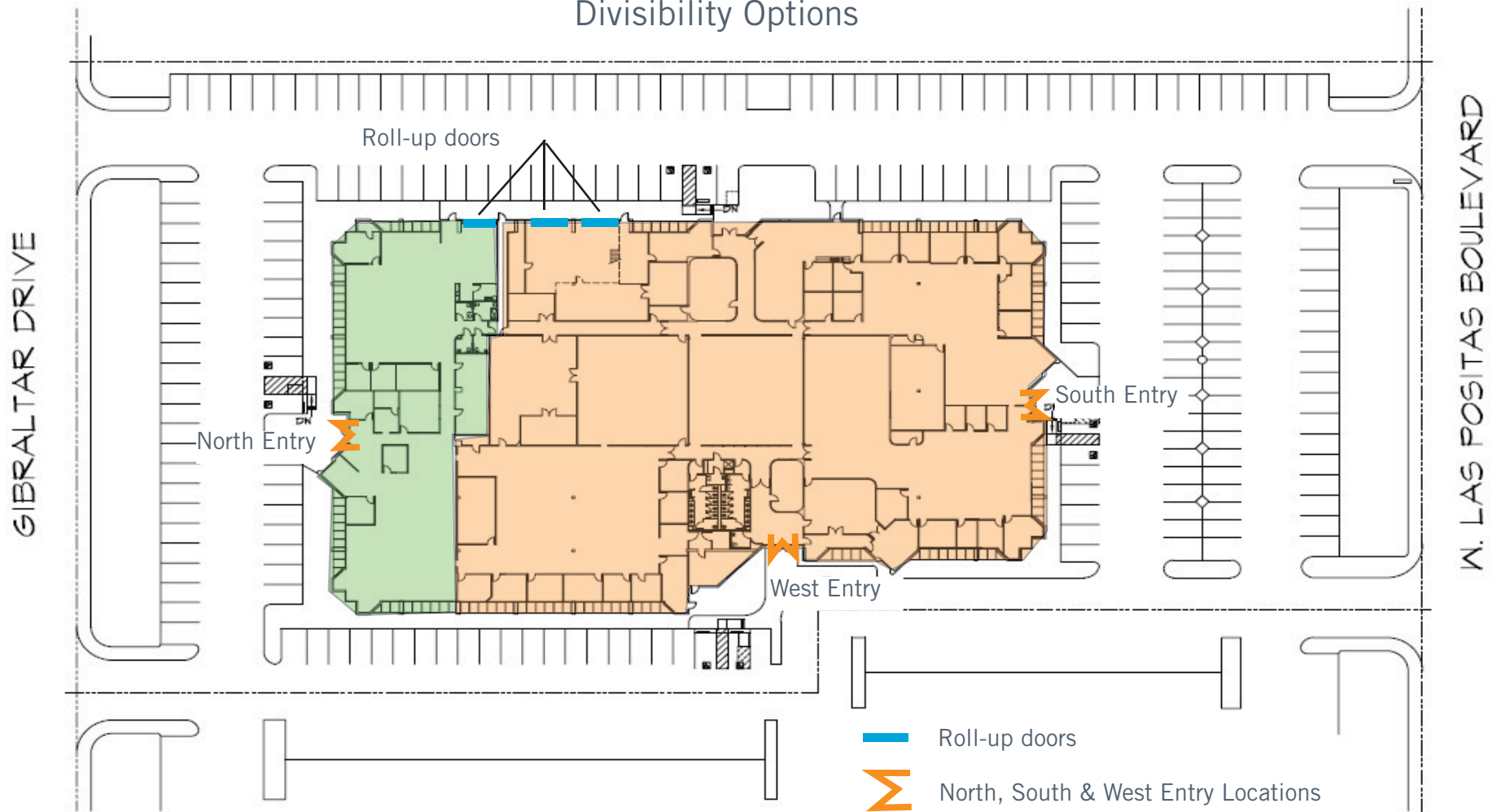

For more information, please contact:

Justin Grilli
Vice President
925-621-3858
jgrilli@ctbt.com
LIC #01410373

Michael Copeland
Managing Partner
925-621-3855
mcpeland@ctbt.com
LIC #00898210

5000 Hopyard Road, Suite 205
Pleasanton, California 94588
ph: 925-621-3840
fx: 925-621-3841
www.cassidyturley.com

TERRENCE J. ROSE, INC.
REAL ESTATE

INVESTMENT & DEVELOPMENT