

# MARATHON BUSINESS PARK

## FOR SALE OR LEASE



1401 - 1499 GREENVILLE ROAD, 30,055± SF BUILDING C  
1501 - 1599 GREENVILLE ROAD, 30,055± SF BUILDING D  
DIVISIBLE TO 6,567± SF

### FOR MORE INFORMATION PLEASE CONTACT:

**BRETT HOLDEN**  
925.737.4158

DPEARSON@LEE-ASSOCIATES.COM

**MARK PLEIS**  
925.737.4148

MPLEIS@LEE-ASSOCIATES.COM

### PROJECT FEATURES

- OUTSTANDING MANUFACTURING, OFFICE/FLEX, INDUSTRIAL BUILDING
- CONVENIENT ACCESS TO AND FROM I-580 VIA GREENVILLE AND VASCO ROADS
- CLOSE PROXIMITY TO THE ALTAMONT COMMUTER EXPRESS TRAIN
- BUILDING POWER: 2,000 AMPS, 480/277 VOLTS, 3 PHASE
- PARKING: OVER 3/1,000± SF

### BUILDING AND SUITE AMENITIES

- 200 AMPS TO EACH CONDOMINIUM
- MINIMUM CLEAR HEIGHT: 16'
- 12' x 13.5' GRADE LEVEL ROLL-UP DOOR
- 0.60 GPM/3,000± SF SPRINKLER DENSITY



# MARATHON BUSINESS PARK

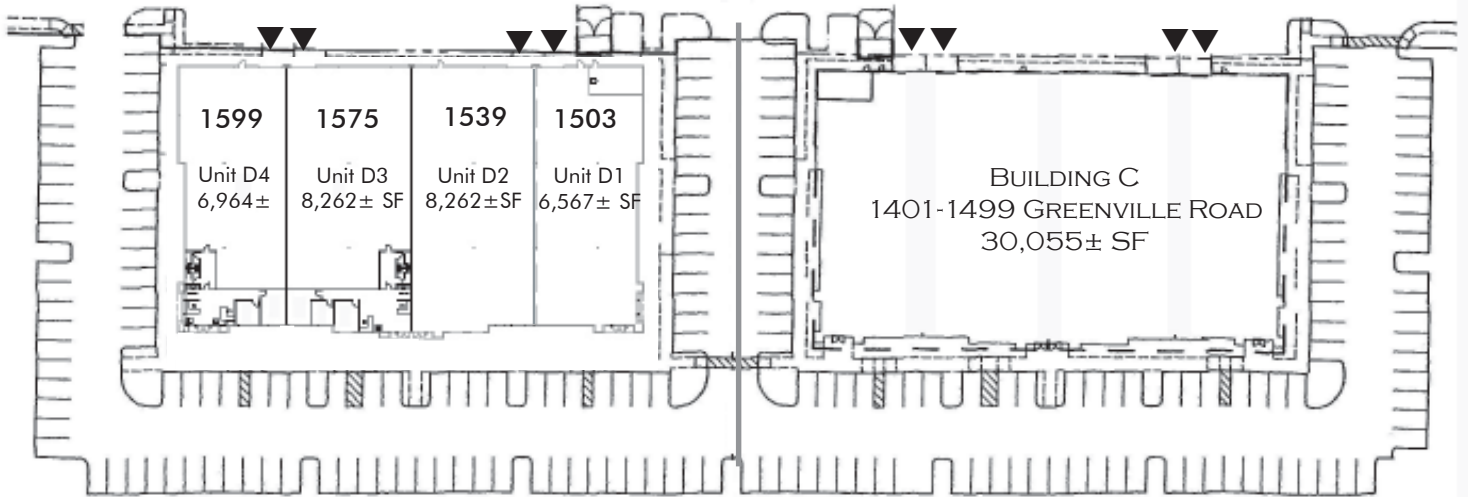

▼▼ GRADE LEVEL DOOR

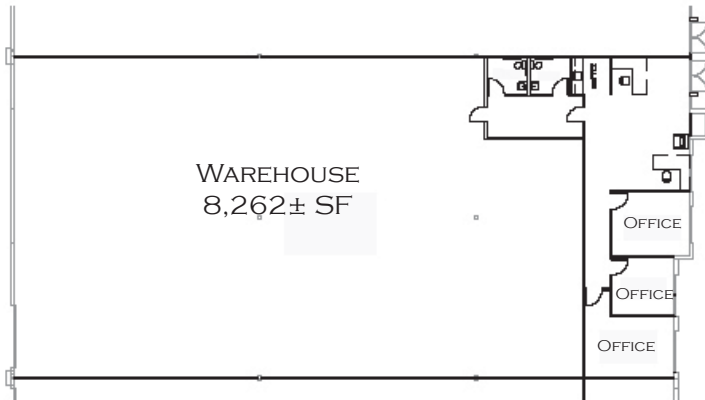

BUILDING D SPEC CONDO  
1575 GREENVILLE ROAD

BUILDING D SPEC CONDO  
1599 GREENVILLE ROAD

