

Livermore Airway Business Park

TERRENCE J. ROSE, INC.
REAL ESTATE

INVESTMENT & DEVELOPMENT

L I V E R M O R E , C A L I F O R N I A



496 Lindbergh Ave.

Project 11
Building 1
763 +/- sq. ft.

OfficeSpace
for Lease

- Convenient I-580/Airway Blvd. Freeway Accessibility
- On-Site Property Management
- Unit Size 763+/- s.f.
- 3 Parking Stalls Included
- Tenant Controlled HVAC
- Comcast & AT&T Availability
- Sprinklered & Insulated
- Nearby Tenant Services, Restaurants, Wineries, Golf Courses, Tower-Controlled Airport, 24 Hour Fitness

For Information Contact:

Jennifer Walker

Phone 925 455 1234 • Fax 925 455 1546

email: jwalker@tjrinc.com web site: www.tjrinc.com

2600 Kitty Hawk Road, Suite 100, Livermore, California 94551

Project 11/Building 1 – 494 & 496 Lindbergh Ave.

L I V E R M O R E , C A L I F O R N I A

Building Floor Plan

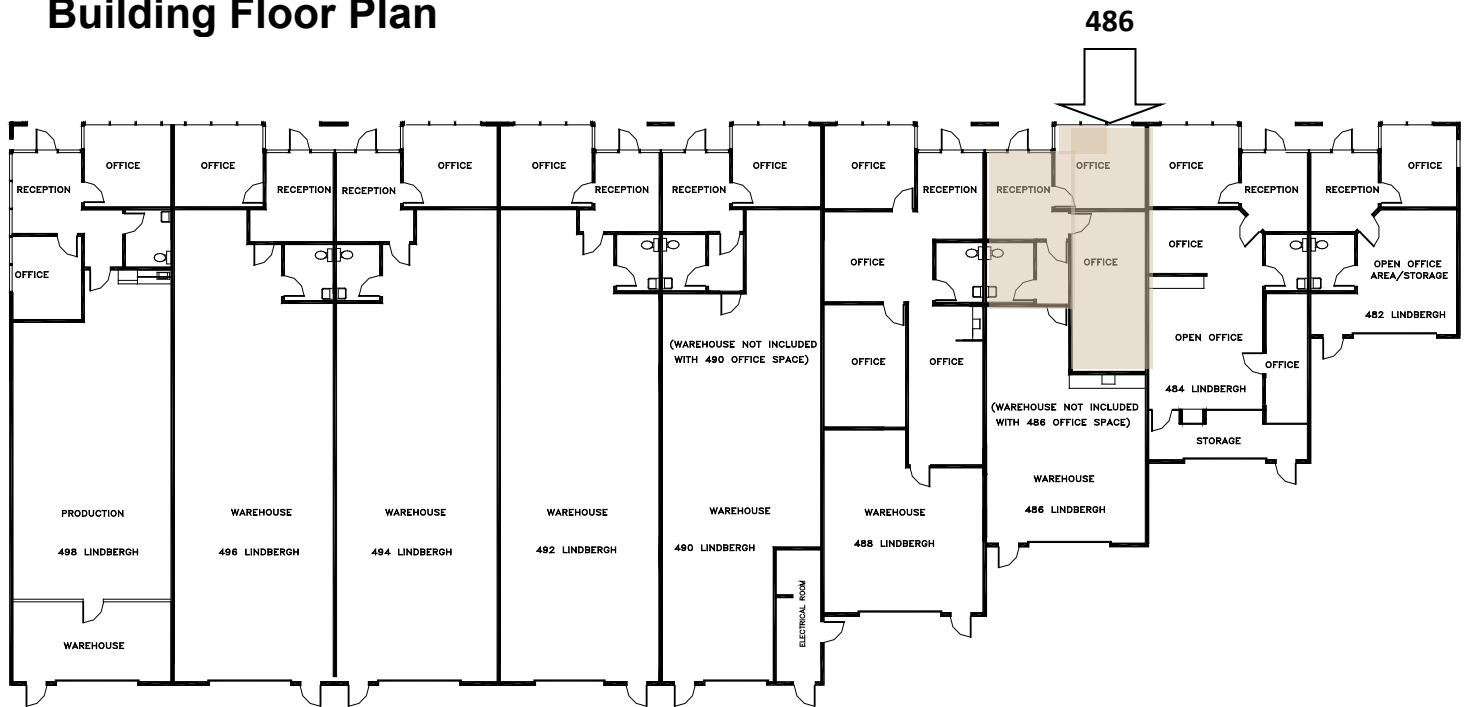

(Floor plan accuracy not warranted and may be changed or updated without notice.)

Available Space

[486 Lindbergh Ave. – 763+/- s.f. – \\$2.25 sq. ft.](#)

(*3 year lease term required. Quoted rates are for spaces AS-IS. Rates, terms, and availability subject to change or withdrawal without notice.)

Map



MAP NOT TO SCALE

For Information Contact:

Jennifer Walker

Phone 925 455 1234 • Fax 925 455 1546

email: jwalker@tjrinc.com website: www.tjrinc.com

2600 Kitty Hawk Road, Suite 100, Livermore, California 94551

